

213R-103598 REV.: 2

REV.

DESCRIPTION

DATE

BY

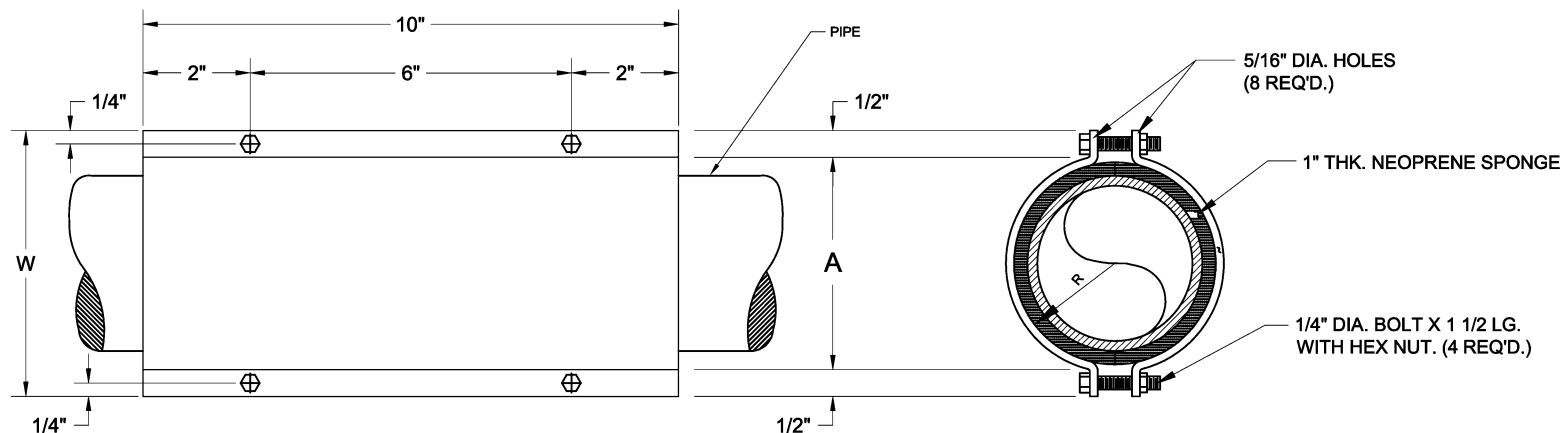

QTY.	PIPE SIZE (NOMINAL)	W	A	R
	3/4"	4.33"	3.33"	1.53"
	1"	4.59"	3.59"	1.66"
	1 1/4"	4.93"	3.93"	1.83"
	1 1/2"	5.17"	4.17"	1.95"
	2"	5.64"	4.64"	2.19"
	2 1/2"	6.15"	5.15"	2.44"
	3"	6.77"	5.77"	2.75"
	3 1/2"	7.27"	6.27"	3.0"
	4"	7.77"	6.77"	3.25"

QTY.	PIPE SIZE (NOMINAL)	W	A	R
	5"	8.83"	7.83"	3.78"
	6"	9.89"	8.89"	4.31"
	8"	11.89"	10.89"	5.31"
	10"	14.03"	13.03"	6.38"
	12"	16.03"	15.03"	7.38"
	14"	17.27"	16.27"	8.0"
	16"	19.27"	18.27"	9.0"
	18"	21.27"	20.27"	10.0"
	20"	23.27"	22.27"	11.0"

**NOTE:**

- 1) NOT FOR USE WITH FIRE RATED WALLS OR FLOORS.
- 2) FINISH:
  - ☐ STANDARD: SHEET METAL CLEANED AND PAINTED WITH INDUSTRIAL ENAMEL.
  - ☐ OPTIONAL: (RECOMMENDED FOR OUTDOOR APPLICATIONS) SHEET METAL HOT-DIP GALVANIZED.
- 3) OTHER LENGTHS AVAILABLE.

OTHER MATERIALS, COMPOUNDS, OR FINISHES WITH EQUAL OR SUPERIOR PROPERTIES MAY BE SUBSTITUTED AS THEY BECOME AVAILABLE.

**CERTIFIED FOR:**

JOB NAME: \_\_\_\_\_

CUSTOMER: \_\_\_\_\_

CUSTOMER P.O.: \_\_\_\_\_

SALES ORDER: \_\_\_\_\_

## MODEL NSW SPLIT SLEEVES FOR ISOLATION OF PIPE PENETRATION WALLS AND FLOORS



**THE VMC GROUP**  
The Power of Together  
Bloomingdale, NJ 07403  
Houston, TX 77041

SCALE:

NONE

SHEET:

Member  
**VISCMA**

DRAWING NO.:

REVISION